



RERA NO.: UPRERAPRJ656513/08/2025
DATE : 26.03.2025 | RERA WEBSITE : www.up-rera.in
PROJECT COLLECTION BANK A/C DETAILS
NAME OF ACCOUNT - PRASANDI INFOTECH PARK PRIVATE LIMITED
ACCOUNT NUMBER - 777705348807
BANK NAME - ICICI BANK LTD
BRANCH NAME - GAMMA, GREATER NOIDA
BRANCH ADDRESS - S-4, GAMMA SHOPPING COMPLEX,
GREATER NOIDA, GAUTAM BUDDHA NAGAR, UTTAR PRADESH, PIN-201306
IFSC CODE - ICIC0003488

BiiGTECH

MARKING YOUR TERRITORY

Marking Your Territory

Biigtech excel in real estate innovation and excellence. Our tagline, Marking Your Territory, captures our mission to transform spaces into vibrant communities, bustling commercial hubs, and luxurious homes.

Vision and Ambition: We see potential in every piece of land, turning it into landmarks of growth and prosperity for both Biigtech and our clients.

Empowerment and Ownership: We empower clients to have their own desirable spaces, whether it's a business district, residential area or industrial park, providing the foundation for dreams to be built and futures to be secured.

Innovation and Excellence: Using cutting-edge technology, sustainable practices, and innovative design, we would be creating lasting spaces and set new standards in real estate.

Community and Connectivity: Our projects would foster faster connection, convenience, and a time of belonging, creating spaces where people can live, work, and thrive. Investing in Biigtech means partnering in growth, innovation, and excellence. Join us in marking

*Artistic Image



DIFFERENT VIEWS

Corner Full View



Aerial View



Plaza View



Top View



THE heart *Of* BUSINESS HUB

Knowledge Park 3 in Greater Noida is a prominent area known for its educational institutions and commercial establishments. The population distribution in terms of residential, working professionals, and students can be estimated, but specific numbers may vary over time and are not always readily available. Here is a general idea based on typical trends:

1. Residential Population:

Knowledge Park 3 primarily features a mix of residential and commercial properties. Residential areas include apartments and housing societies. The residential population might be around 10 to 20 lakh (1 to 2 million) people, but this is a rough estimate and could be higher or lower depending on recent developments and housing projects.

2. Working Professionals:

The area hosts numerous offices and business establishments, contributing to a significant population of working professionals. The number of professionals working in Knowledge Park 3 might range between 5 to 10 lakh (0.5 to 1 million) individuals. This includes employees in various sectors, including IT, education and other services.

3. Students:

Knowledge Park 3 is home to several educational institutions, including universities and colleges. The student population could be substantial, potentially ranging from 1 to 3 lakh (0.1 to 0.3 million) students. This includes both full-time students and those attending evening or part-time classes.

One of its Finest RETAIL HUB

BiigTECH
MARKING YOUR TERRITORY
GREATER NOIDA

Biigtech Tower redefines business spaces with a cutting-edge blueprint focused on innovation and efficiency.

Our design combines modern architecture, smart technologies, and flexible layouts, offering premium office suites, high-visibility retail spaces, and business lounges.

Key features include advanced infrastructure, energy-efficient systems, ample parking, and prime connectivity within Greater Noida's commercial hub. Biigtech Towers is more than just a workspace-it's a platform for growth, tailored to meet the diverse needs of forward-thinking businesses.

Front View

*Artistic Image



A Destination where the barriers between work and public spaces start to break down.



CONNECTIVITY

- Near Yamuna & Noida-Greater Noida Expressway
- Close To Knowledge Park II Metro(Aqua Line)
- Connected To Greater Noida Residential Sectors

COMFORT

- IT spaces
- Office Spaces
- Retail Hub
- Food Court



enjoy
The 4C
Advantage

CONVENIENCE

- Operational Metro Line
- Reputed Hospitals
- Industrial Hub
- Premium Work Spaces
- World Class Retail



CAPITAL APPRECIATION

- Close to major highways and metro lines.
- New projects boosting property demand.
- Top institutions drive investment interest.
- Smart city projects supporting long-term growth.



Where business and footfall come together

A destination designed to deliver growth, visibility, and endless opportunities.

Welcome to “BiigTech” — a modern commercial hub crafted to bring together thriving businesses, vibrant retail spaces, and a steady stream of visitors. Strategically located at the heart of growth, BiigTech offers a seamless blend of premium infrastructure, contemporary design, and high consumer engagement.

Whether you're an investor, retailer, or entrepreneur, BiigTech is where your business finds its perfect stage. With high visibility frontage, excellent connectivity, and a curated tenant mix, every square foot here is designed to attract attention and convert footfall into real business.

At BiigTech, every element — from open walkways to retail zones, entertainment spaces, and offices — has been thoughtfully planned to ensure one thing: maximum visibility, maximum returns.

Key Highlights:

- Prime Location: Strategically positioned for maximum accessibility and visibility.
- High Footfall Zone: Surrounded by dense residential and commercial catchment areas.
- Smart Design: Optimized layouts for retail, entertainment, and office use.





FLOOR PLANS

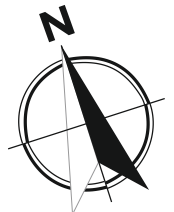



RETAIL SPACE

IMAGE FOR REPRESENTATION PURPOSE ONLY

*Artistic Image



IMAGE FOR REPRESENTATION PURPOSE ONLY



RETAIL SPACE

IMAGE FOR REPRESENTATION PURPOSE ONLY

*Artistic Image

UPPER GROUND FLOOR PLAN
PLOT NO. 21, KNOWLEDGE PARK 3, GREATER NOIDA

T-UG: TERRA ZONE
A-UG: AQUA ZONE
B-UG: BREEZE ZONE
S-UG: SKYE ZONE

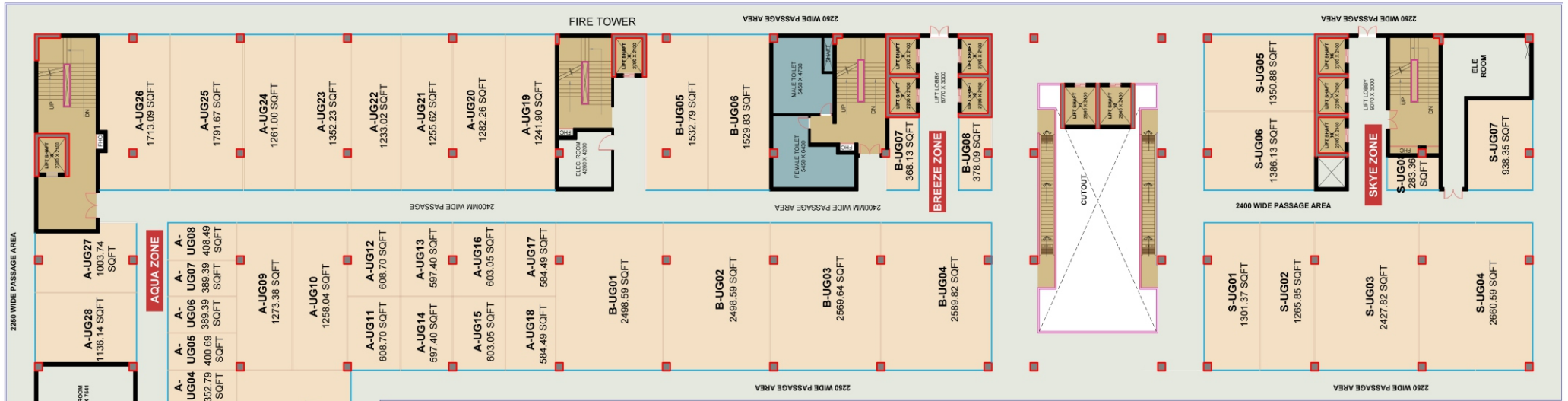

IMAGE FOR REPRESENTATION PURPOSE ONLY



RETAIL SPACE

IMAGE FOR REPRESENTATION PURPOSE ONLY

Artistic Image



IMAGE FOR REPRESENTATION PURPOSE ONLY



FOOD COURT

IMAGE FOR REPRESENTATION PURPOSE ONLY

*Artistic Image

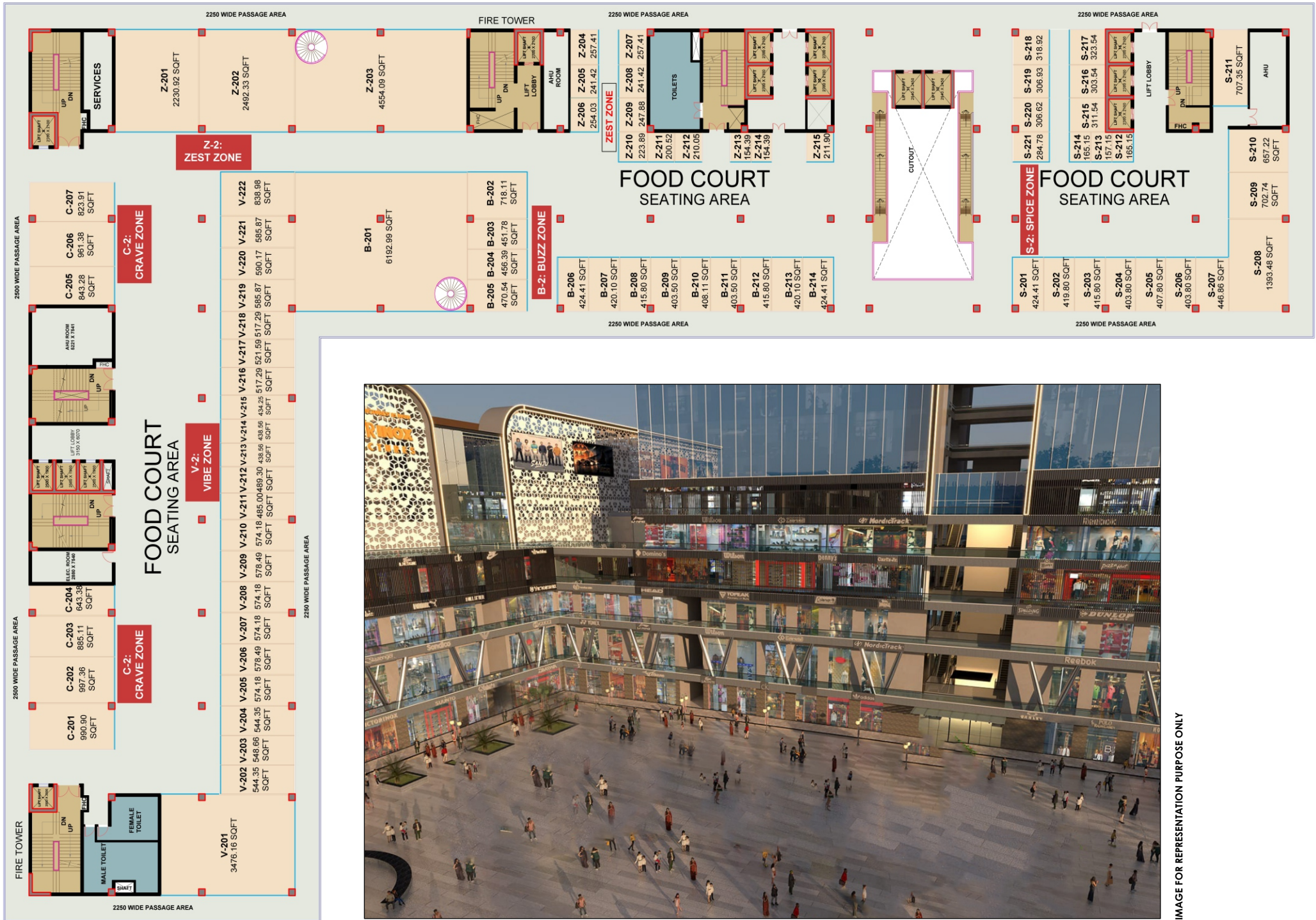

IMAGE FOR REPRESENTATION PURPOSE ONLY



MULTIPLEX

IMAGE FOR REPRESENTATION PURPOSE ONLY

*Artistic Image



IMAGE FOR REPRESENTATION PURPOSE ONLY



CO-WORKING SPACE

IMAGE FOR REPRESENTATION PURPOSE ONLY

*Artistic Image





OFFICE SPACE

IMAGE FOR REPRESENTATION PURPOSE ONLY

*Artistic Image







IMAGE FOR REPRESENTATION PURPOSE ONLY

*Artistic Image

CORPORATE OFFICE/ ENTERTAINMENT ZONE



Corporate Office / Entertainment Zone

Biigtech- Greater Noida - Project Highlights

- 1. Premium Commercial Project in Knowledge Park 3, Greater Noida.**
- 2. Diverse Offerings: Food Court, Gaming Zone, Retail, Offices & Studio Apartments.**
- 3. Strategic Location Surrounded by Colleges, IT Hubs & Residences.**
- 4. Excellent Connectivity via Yamuna & Noida-Greater Noida Expressways.**
- 5. Close to Operational Metro (Knowledge Park II, Aqua Line).**
- 6. Future Road Link to Sector 146 & Advant Navis Business Park (12 mins away).**
- 7. Fully Paid-Up Land with Transparent Investment Terms.**
- 8. Bank Loan Facility with Construction Linked Payment Plans.**
- 9. High Footfall Potential due to Mixed-Use Commercial Spaces.**
- 10. Proximity to Top Landmarks: SEZ, DLF Techpark, MetLife, NTT, EXL, etc.**
- 11. Upcoming Hindon River Bridge & 60m Road Projects to Ease Traffic.**
- 12. Metro Expansion to Boost Regional Connectivity (Botanical Garden-142 Line).**
- 13. Surrounding Growth: Godrej Tropical Isle, Jardinia, Gulshan Dynasty Nearby.**
- 14. Modern Amenities, Green Features & Developer with Proven Track Record.**

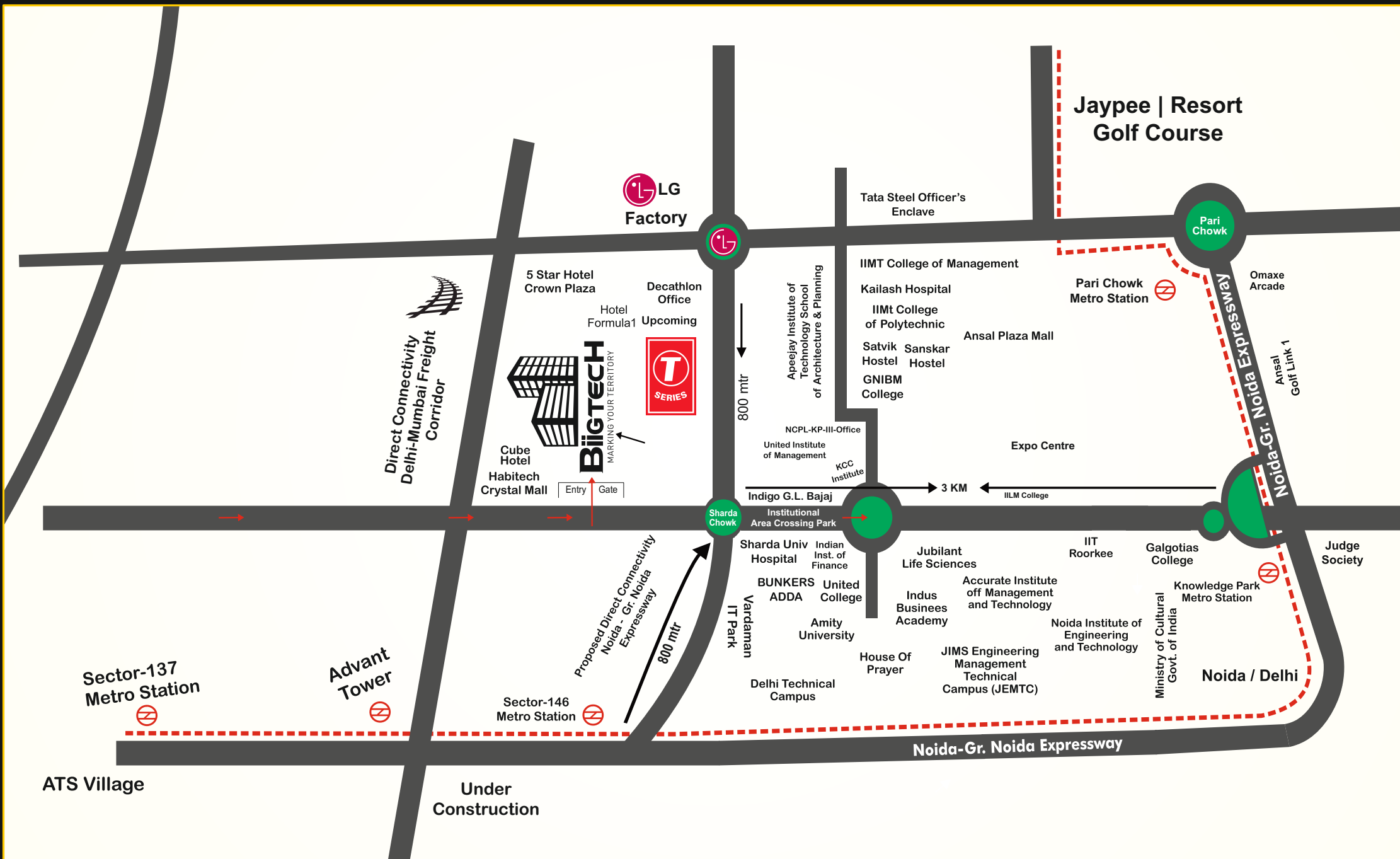

Distance (km)	Distance (km)	Distance (km)	Distance (km)	Distance (km)	Distance (km)
Sharda University & Hospital / Kailash Medical Institute	Across the road	Metro transit connectivity Pari Chowk / Jaypee Gold Resort	~3 km	Entertainment & Sports Corridor	~5 km
Medical & Educational Hub	<2 min drive	Major Intersection, Transport hub Yamuna & Eastern Paripheral Expressway	~5 km	Jewar International Airport	~30 Min.
India Expo Mart / LG Chowk	~2 km	High-speed expressway access FNG Expressway	~7 km	Advant, Sector-142, Noida	10 Minutes
Event & Commercial access Knowledge Park Metro Station (Aqua Line)	~2 km	Regional road network F1 Racing Track / International Cricket Stadium	~8 km	Residential & Commercial linkage Mathura & Vrindavan	~100 km



*ARTISTIC IMAGE

BiigTECH

MARKING YOUR TERRITORY

PRASANDI INFOTECH PARK PVT. LTD.

🌐 www.biigtech.in | ✉ info@biigtech.in

📍 Plot No. 21, Knowledge Park 3, Greater Noida, UP, 201308

Disclaimer: - This advertisement is for information purposes only. Biigtech is a commercial project by Prasandi Infotech Park Pvt. Ltd. The images, visuals, layouts, specifications, facilities, amenities, and surroundings shown are indicative/artist's impressions for representational purposes only and subject to approval from competent authorities and change without prior notice. The developer/promoter reserves the right to make alterations or amendments as may be required by law, or as directed by concerned authority, or deemed necessary for developmental interest. The project is RERA registered buyers to independently verify all project details and approvals.

RERA Registration No. - UPRERAPRJ656513/08/2025. For complete details, please refer to the official RERA website: www.up-rera.in